

# GENERIC E Adapter BLE Bluetooth

## SkyDemon (SD) EXPERIMENTAL

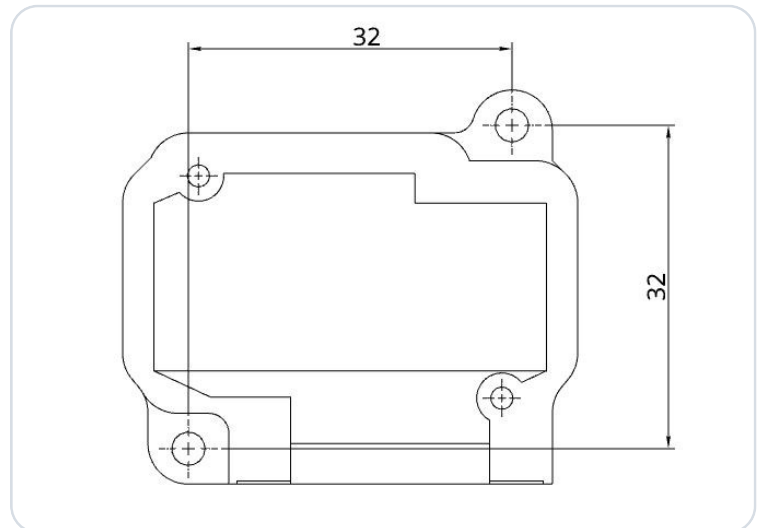

Bluetooth Low Energy Adapter (BLE) developed for the navigation software SkyDemon (SD). It enables data transfer between the navigation software (SD) and the avionics hardware (BLE ↔ RS-232).

Set the frequencies of your VHF transceiver, control your autopilot, feed your AV-30 with this Bluetooth adapter directly from the SkyDemon app.

This adapter has only the basics you need to connect the SkyDemon navigation software with your avionics. Mount it somewhere behind the panel, connect power and distribute the signals to the devices. Yes, this sounds like tinkering... but that's what you want ;-)

The adapter can be operated with 12 V and 24 V on-board voltage. An internal mini-fuse (125 mA) is integrated in the housing. The power supply is protected against reverse polarity and short-circuit proof.

**The pin assignment of the connector corresponds to the connection of the f.u.n.k.e ATR833S, ATR833-II and ATR833A-II remote connector!**

### IMPORTANT

This is a prototype for exclusively experimental use!!!

**IMPORTANT****Do not pair the SD-Link in the Bluetooth settings**

The SD-Link adapter is a Bluetooth Low Energy (BLE) device. BLE devices are not paired via the Bluetooth settings of your tablet or phone like regular Bluetooth devices such as headsets or speakers.

Therefore, please do not open the Bluetooth settings of iOS, Android or Windows to search for or pair the SD-Link there.

The connection to the SD-Link is set up exclusively within the navigation app itself, e.g. in SkyDemon, Sky-Map, VFRnav, EasyVFR or another supported app. Pairing at operating-system level is not required and can even prevent the connection.

Regular Bluetooth devices such as headsets, intercoms or speakers can still be used in parallel. They are paired via the operating system as usual. The SD-Link, however, is addressed directly by the navigation app.

**If the SD-Link has already been paired in the Bluetooth settings:** Please remove the SD-Link completely from the Bluetooth device list of your tablet or phone. Do not pair it again via the operating system afterwards; instead, set it up again exclusively within the navigation app.

**REMEMBER**

**Do not pair the SD-Link in the operating system.  
Always set up the SD-Link directly in the navigation app.**

## 1 Radio Configuration

Must be performed according to the respective device.

## 2 Connector Pin Assignment

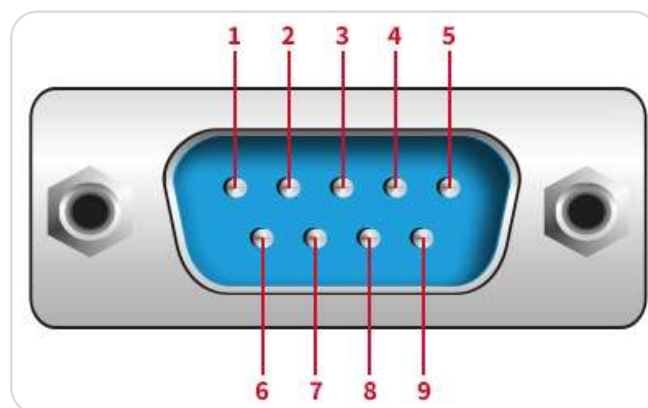

Figure 1 · Connector pin assignment

Pin	Function
Pin 2	Data RXD
Pin 3	Data TXD (V24 data output!)
Pin 5	GND
Pin 8	Power (+ 5 ... 28 V)

The pin assignment of the connector corresponds to the connection of the f.u.n.k.e ATR833S, ATR833-II and ATR833A-II remote connector and is therefore a PnP solution for these devices.

The remote connector is included in the following cable harnesses:

- BSKS833S-S
- BSKS833D-S
- BSKS833OE-S
- BSKS833GLS-S
- BSKS833GLD-S

### 3 Contact

For problems, questions, suggestions or even positive feedback please contact:

#### LayCom Vision GmbH – SD-Link

Michael Hoffmann

Chausseestr. 46  
D-15518 Rauen, Germany

E-Mail [info@sdlink.de](mailto:info@sdlink.de)

Phone [+49 3361 710253](tel:+493361710253)

Web [www.sdlink.de](http://www.sdlink.de)

