

GENERIC E Adapter BLE Bluetooth

easyVFR EXPERIMENTAL

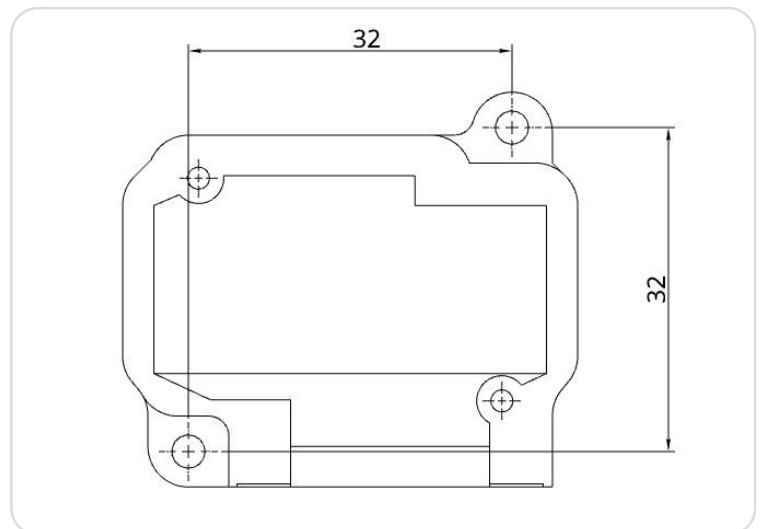

Bluetooth Low Energy Adapter (BLE) developed for the navigation software easyVFR. It enables data transfer between the navigation software (SD) and the avionics hardware (BLE ↔ RS-232).

Set the frequencies of your VHF transceiver, control your autopilot, feed your AV-30 with this Bluetooth adapter directly from the easyVFR app.

This adapter has only the basics you need to connect the easyVFR navigation software with your avionics. Mount it somewhere behind the panel, connect power and distribute the signals to the devices. Yes, this sounds like tinkering... but that's what you want ;-)

The adapter can be operated with 12 V and 24 V on-board voltage. An internal mini-fuse (125 mA) is integrated in the housing. The power supply is protected against reverse polarity and short-circuit proof.

The pin assignment of the connector corresponds to the connection of the f.u.n.k.e ATR833S, ATR833-II and ATR833A-II remote connector!

IMPORTANT

This is a prototype for exclusively experimental use!!!

1 Radio Configuration

Must be performed according to the respective device.

2 Connector Pin Assignment

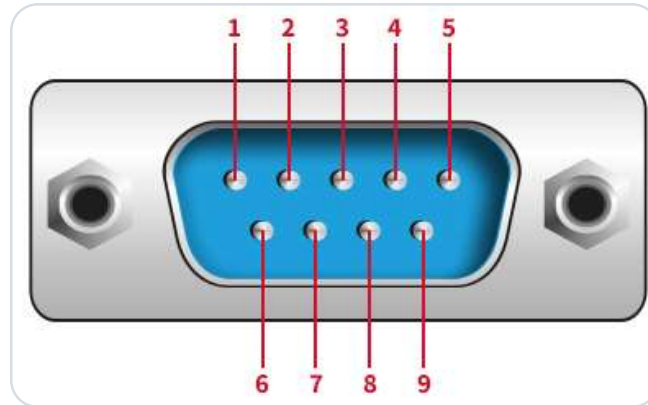

Figure 1 · Connector pin assignment

Pin	Function
Pin 2	Data RXD
Pin 3	Data TXD (V24 data output!)
Pin 5	GND
Pin 8	Power (+ 5 ... 28 V)

The pin assignment of the connector corresponds to the connection of the f.u.n.k.e ATR833S, ATR833-II and ATR833A-II remote connector and is therefore a PnP solution for these devices.

The remote connector is included in the following cable harnesses:

- BSKS833S-S
- BSKS833D-S
- BSKS833OE-S
- BSKS833GLS-S
- BSKS833GLD-S

3 Contact

For problems, questions, suggestions or even positive feedback please contact:

LayCom Vision GmbH – SD-Link

Michael Hoffmann

Chausseestr. 46
D-15518 Rauen, Germany

E-Mail info@sdlink.de

Phone [+49 3361 710253](tel:+493361710253)

Web www.sdlink.de

