

TQ KRT2 DS - BLE Bluetooth Adapter

sky-map EXPERIMENTAL

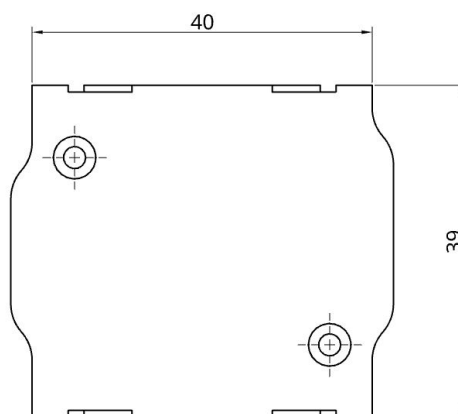

Bluetooth Low Energy Adapter (BLE) for a TQ KRT2 VHF transceiver (aviation radio). The adapter is compatible with radios of the following type series:

- KRT2-S
- KRT2-F
- KRT2-P

The adapter was developed as an interface for the TQ KRT2 for compatible navigation apps (e.g. sky-map) and works together with an EFIS. It enables data transfer between the navigation app and the radio hardware (BLE ↔ RS-232). The adapter is simply plugged between the existing wiring and the radio and is held securely to the housing thanks to the Conec latch system.

An additional power supply is not required. The adapter can be operated with 12 V and 24 V onboard voltage. An internal mini-fuse (125 mA) is integrated in the housing.

The power supply is protected against reverse polarity and short-circuit-proof. **No further electrical or mechanical work necessary!**

Important: This is a prototype for exclusively experimental use!

1 Radio Configuration

No further configuration of the radio is required.

2 Connector Pin Assignment

This is an excerpt from the TQ installation manual:

Important: Pin 13 of the connector serves as data input from the EFIS.

6.9.2 Connector Pin-Configuration

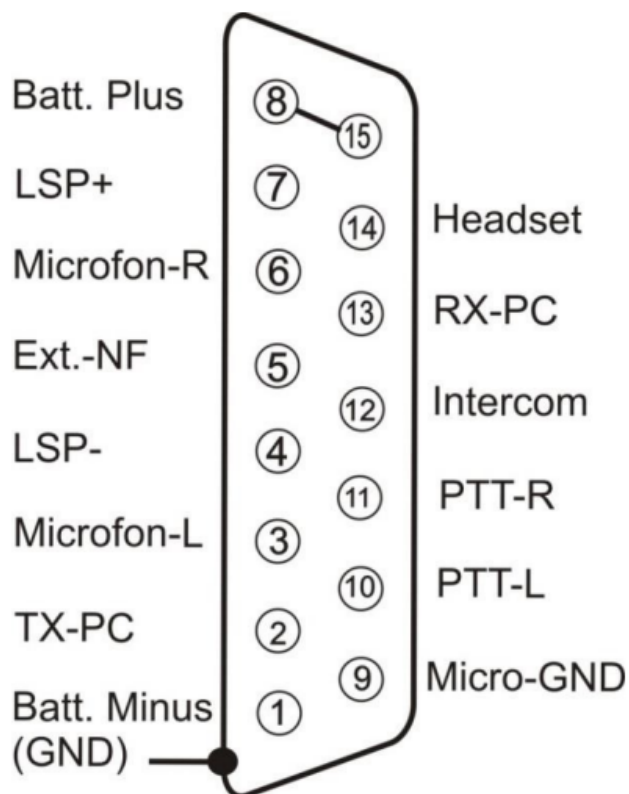
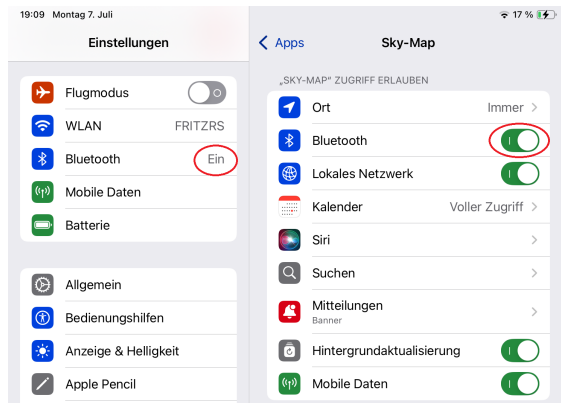

Figure 7: Connector pinout

Figure 1: KRT2 DS Connector Pin Assignment

3 Configuration in sky-map

3.1 Prerequisites and Configuration in iOS



iOS Settings:

1. Bluetooth must be enabled in the iOS settings.
2. Under *Apps/sky-map*, access to Bluetooth must be granted.

3.2 Prerequisites and Configuration in Android

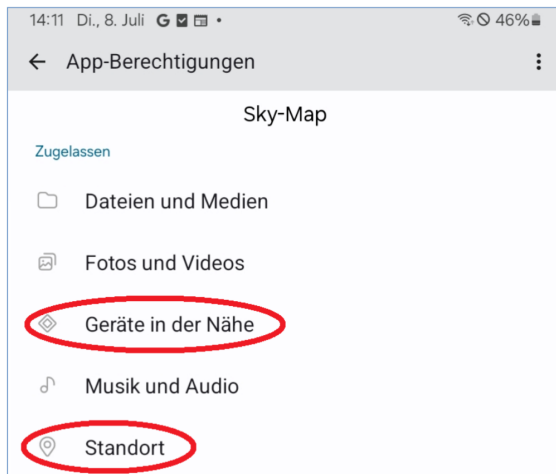

Android Settings:

1. Bluetooth must be enabled in the Android settings.
2. Under *Apps/sky-map*, access to **Nearby devices** and **Location** must be granted.

3.3 Establishing Connection with the Adapter

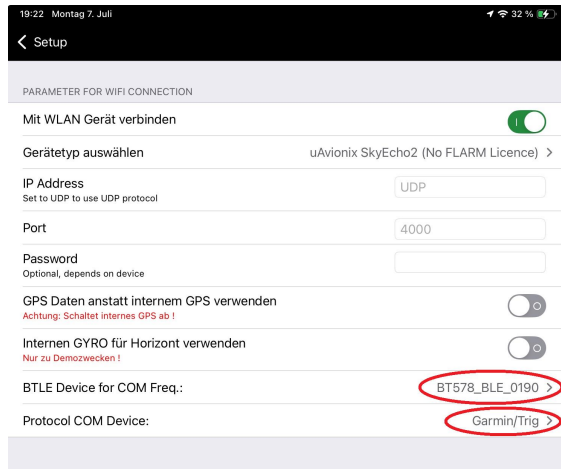

3. Turn on the radio with the adapter.
4. Open in sky-map:
Menü → Setup → Wireless Interface Setup
5. Select **SD-KRT2-DS** (if multiple are available).
6. Select the appropriate protocol for your radio:
TQ KRT2
7. Exit the setup.

At the next program start, sky-map will automatically reconnect to the last selected BTLE adapter.

Important: For the automatic connection at program start to work, the radio and BTLE adapter must be turned on **before** sky-map is started. If this is not the case, the connection must be established manually by accessing the setup (see step 4).

4 Contact

If you have any questions, problems or feedback, please feel free to contact us:

LayCom Vision GmbH – SD-Link
Michael Hoffmann

Chausseestr. 46
D-15518 Rauen, Germany

E-Mail: info@sdlink.de
Phone: +49 3361 710253

