

Generic - BLE Bluetooth Adapter

SkyDemon (SD) EXPERIMENTAL

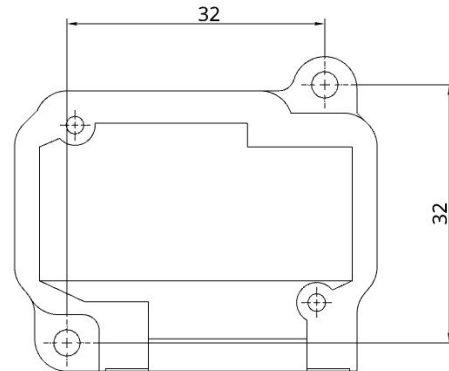

Bluetooth Low Energy Adapter (BLE) for SkyDemon Navigation Software

This adapter was developed as an interface between your avionics and the SkyDemon (SD) navigation software. It enables data transfer between the SkyDemon software and your compatible avionics hardware (BLE <-> RS-232).

Adjust the frequencies of your VHF transceiver, control your autopilot, and feed your AV-30 directly from the SkyDemon app with this Bluetooth adapter.

This adapter includes only the essential functions needed to connect SkyDemon navigation software to your avionics. Simply mount it somewhere behind the panel, connect the power, and distribute the signals to your devices. Yes, this requires some tinkering... but that's what you wanted! ;-)

The adapter operates on 12 V and 24 V board voltage. An internal mini-fuse (125 mA) is integrated into the housing. The power supply is protected against reverse polarity and short circuits.

The pin assignment matches the f.u.n.k.e ATR833S, ATR833-II, and ATR833A-II remote connector!

⚠ Please note: This is a prototype for experimental use only!

1. Radio Configuration

Configuration must be performed according to the respective device specifications.

2. Belegung Steckverbinder

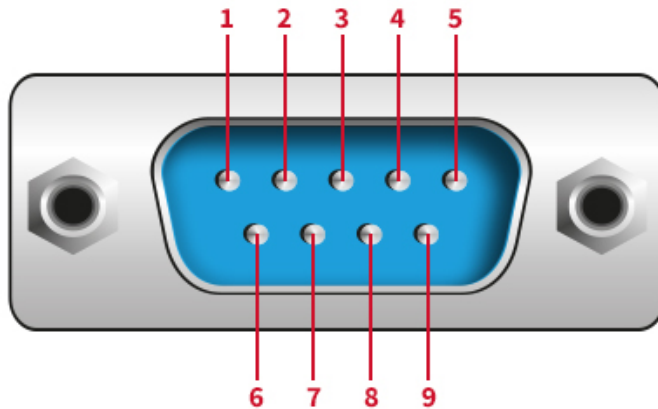

- Pin 2: Data RXD
- Pin 3: Data TXD (V24 data output!)
- Pin 5: GND
- Pin 8: Power (+ 5V to 28 V)

The pin assignment matches the f.u.n.k.e ATR833S, ATR833-II, and ATR833A-II remote connector, making it a Plug-and-Play solution for these devices.
The remote connector is included in the following wiring harnesses:

- BSKS833S-S
- BSKS833D-S
- BSKS833OE-S
- BSKS833GLS-S
- BSKS833GLD-S

3. Contact Information

For issues, questions, feedback, or positive experiences, please contact:

LayCom Vision GmbH - SD-Link

Michael Hoffmann

Chausseestr. 46

D-15518 Rauen

Germany

Email: info@sdlink.de

Phone: +49 3361 710253

